

SV/FILTER/EC

Filtration units for circular ducts and EC Technology motor

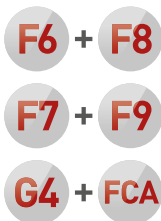

DIFFERENT
FILTRATION STAGES
DEPENDING ON
MODEL:



Filtration units for circular ducts, with low noise level, different filtration stage options and EC Technology motor.

Fan:

- Acoustic casing covered with sound absorbing material.
- Standardised inlet and outlet flanges with watertight joints.
- F6 + F8, F7 + F9 and G4 + CA, filters according to model.
- Easy access inspection and cleaning cover with manual fasteners.
- Centrifugal fan with a backward curved impeller.
- Integrated support into the box which facilitates its assembly.
- Linear airflow direction.
- 3 pressure taps for individual control of the two filtration stages.

• Installation in any position.

- With guide slot for 25 mm prefilter.
- More efficient filter anti-by-pass adjustment.

Motor:

- High efficiency external rotor EC Technology motors, adjustable via 0-10 V signal.
- Single-phase 220-240 V 50/60 Hz, IP54 protection.
- Maximum temperature of air to be carried: -25 °C +60 °C.

Finish:

- Anti-corrosive in galvanized steel sheet.

Order code

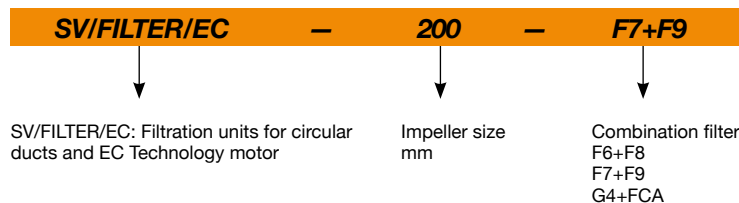

Technical characteristics

Model	Speed (r/min)	Maximum admissible current (A)	Maximum power (W)	Maximum flow rate (m³/h)			Sound pressure level at 50% of max. speed* dB (A)	Approx. weight (Kg)	According ErP
		230V		F6+F8	F7+F9	G4+CA			
SV/FILTER/EC-150	3540	0.97	120	553	527	454	38	14	2018
SV/FILTER/EC-200	3265	1.35	176	768	734	641	45	17	2018
SV/FILTER/EC-250	2850	1.35	180	913	850	744	49	19	2018
SV/FILTER/EC-315	2320	2.00	450	1917	1806	1507	52	34	2018
SV/FILTER/EC-350	1460	1.45	190	1532	1382	1061	42	39	2018
SV/FILTER/EC-400	1700	4.70	750	3279	3024	2428	52	66	2018

* Irradiated sound pressure level in dB(A) at a distance of 1 m.



Erp. (Energy Related Products)

Information on Directive 2009/125/EC can be downloaded from the SODECA website or the QuickFan selector programme.

Acoustic characteristics

Sound power spectrum Lw(A) in dB(A) per Hz frequency band
Irradiated values at maximum speed and medium flow rate.

	63	125	250	500	1000	2000	4000	8000
SV/FILTER/EC-150	56	52	56	54	48	43	39	33
SV/FILTER/EC-200	63	59	63	61	55	50	46	40
SV/FILTER/EC-250	67	63	67	65	59	54	50	44
SV/FILTER/EC-315	69	66	70	67	61	57	53	47
SV/FILTER/EC-350	59	56	60	58	53	50	47	41
SV/FILTER/EC-400	70	66	70	68	62	57	53	47

Dimensions mm

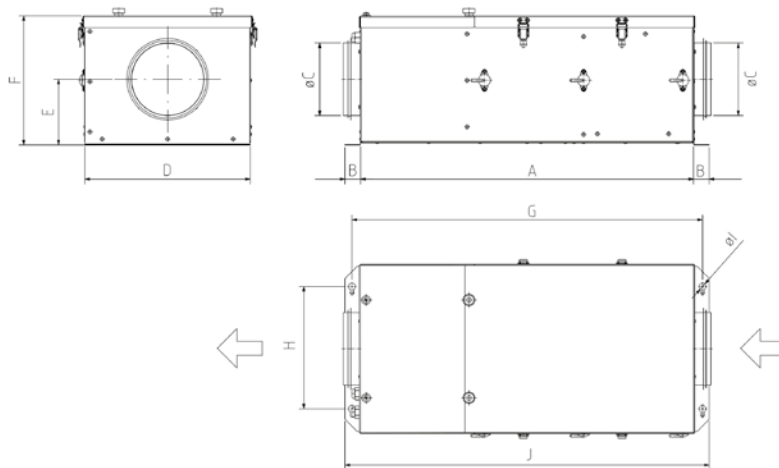

	A	B	ØC	D	E	F	G	H	ØI	J
SV/FILTER/EC-150	680	34.5	150	340	134.5	262.5	715	250	14	750
SV/FILTER/EC-200	700	38.5	200	395	152	300	735	290	14	780
SV/FILTER/EC-250	750	48.5	250	420	162	323	785	335	14	850
SV/FILTER/EC-315	830	58	310	520	202	404	865	435	14	950
SV/FILTER/EC-350	920	56	350	610	223.5	446	955	525	14	1030
SV/FILTER/EC-400	1000	60.5	400	670	251.5	505.5	1030	575	14	1120

Accessories



Characteristic curves

Q= Flow rate in m³/h, m³/s and cfm

Pe= Static pressure in mm H₂O, Pa and inwg

SV/FILTER/EC 150

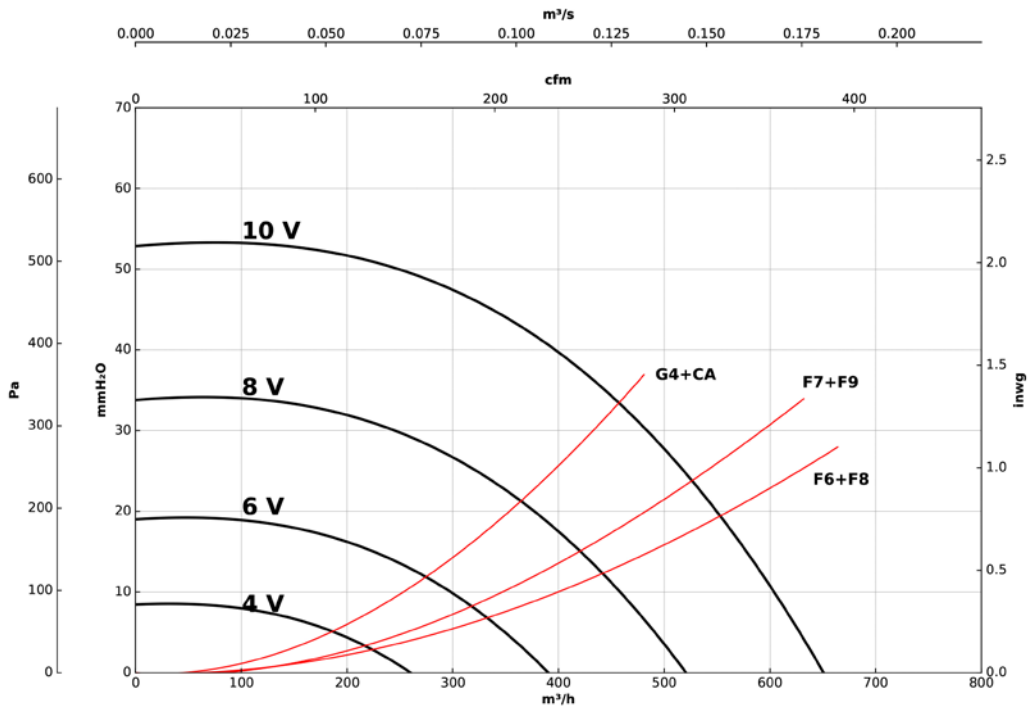

SV/FILTER/EC 200

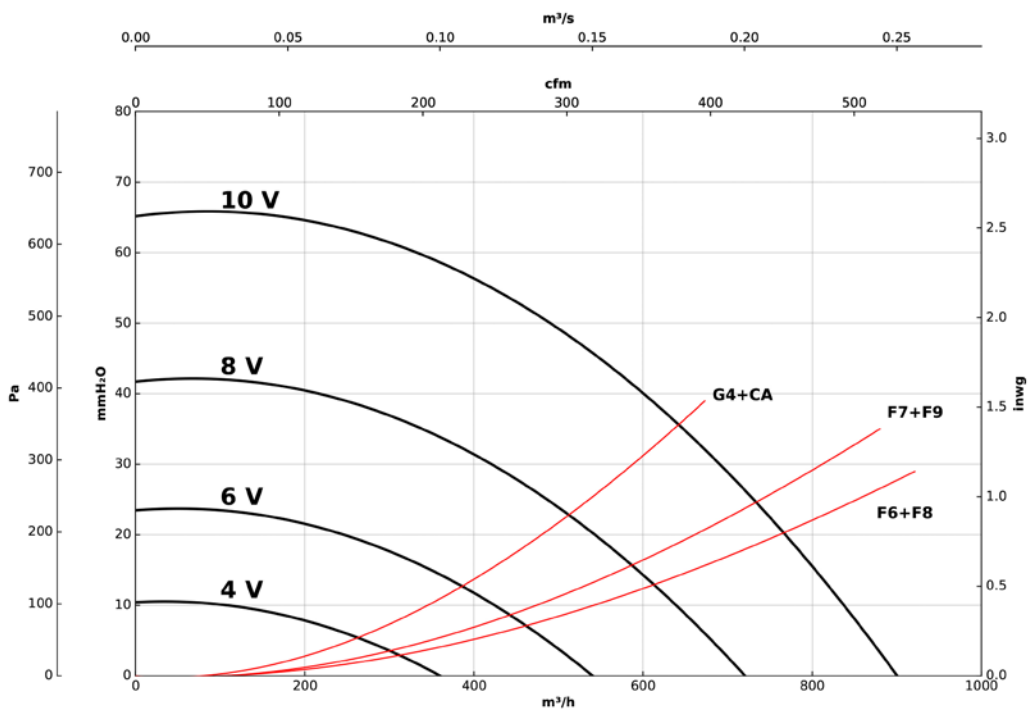

Characteristic curves

Q= Flow rate in m³/h, m³/s and cfm

Pe= Static pressure in mm H₂O, Pa and inwg

SV/FILTER/EC 250

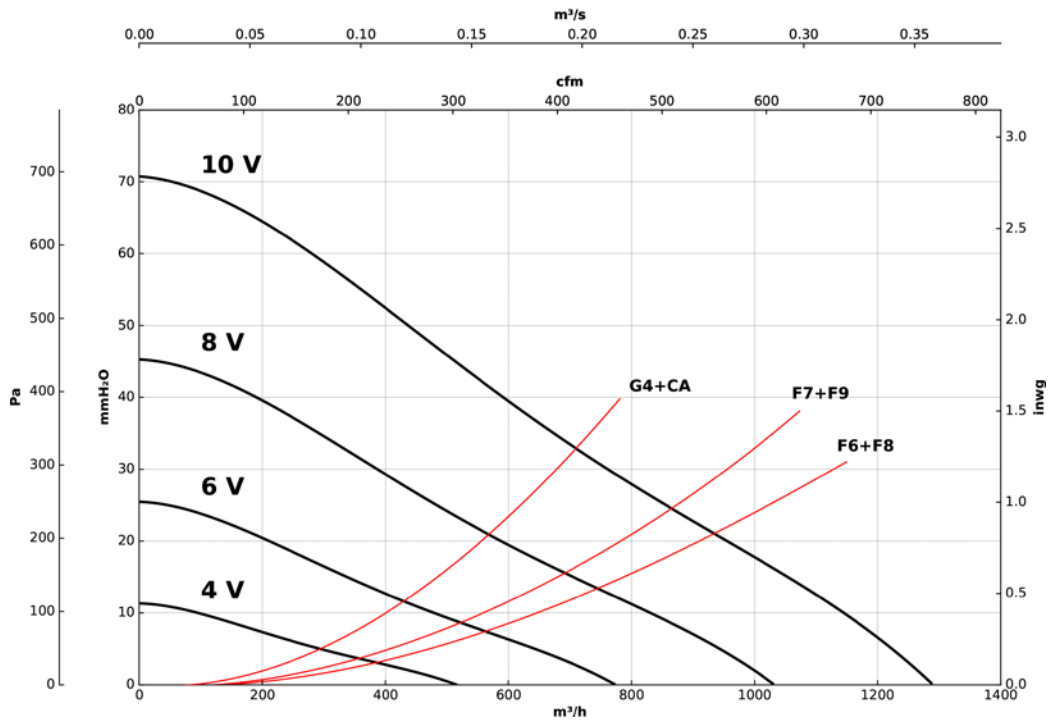

SV/FILTER/EC 315

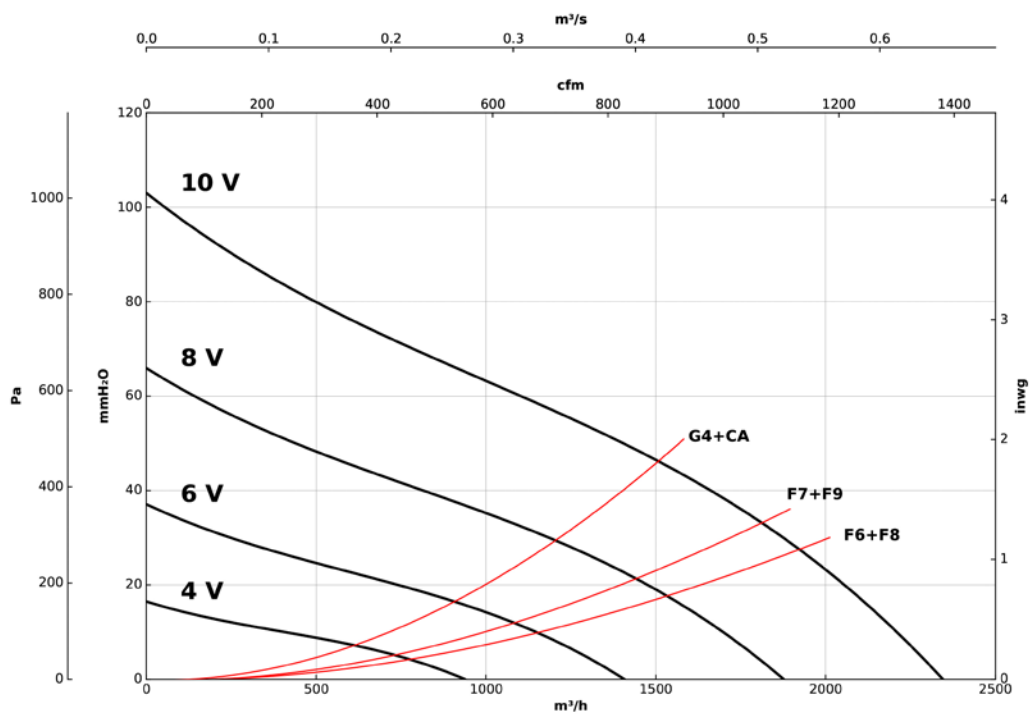

Characteristic curves

Q= Flow rate in m³/h, m³/s and cfm

Pe= Static pressure in mm H₂O, Pa and inwg

SV/FILTER/EC 350

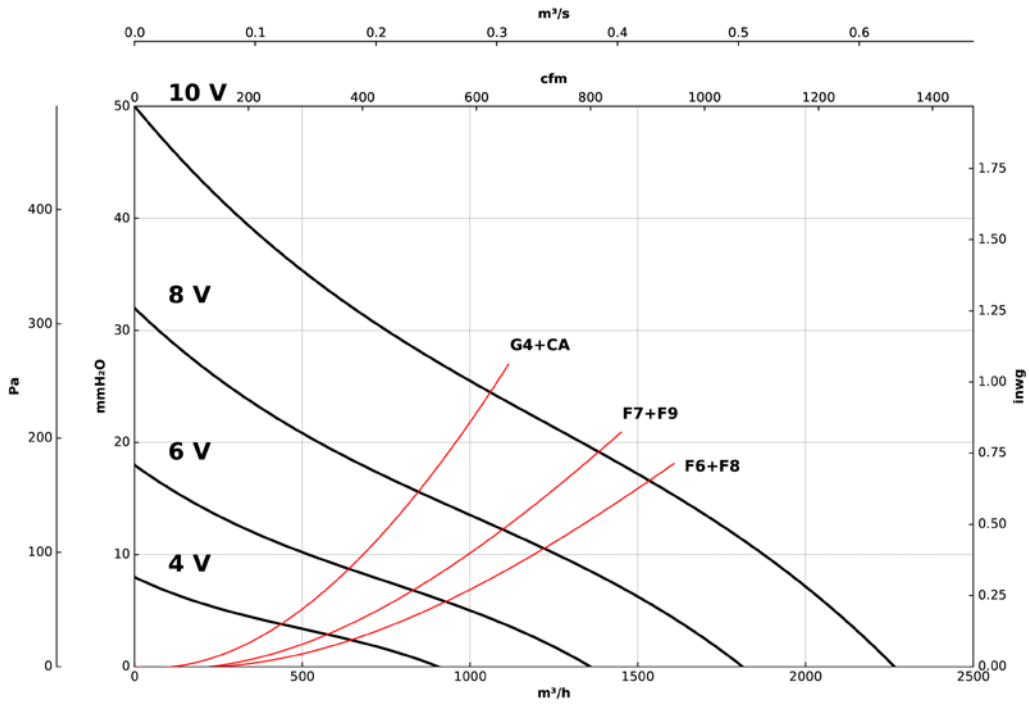

SV/FILTER/EC 400

