

# CJBD/EC/ALS



**Ventilation units with aluminum profile, double insulating wall and EC Technology IE4 motor with integrated electronics**



Ventilation units with forward curved impeller and EC Technology IE4 motor with integrated electronics, specially designed to obtain high energy efficiency.

with integrated electronics, regulated by 0-10 V.

- IE4 efficiency motors, class F and IP54 protection.
- Single-phase 190-250 V 50/60 Hz.
- Working temperature: -25 °C +60 °C.

Fan:

- Galvanized steel sheet casing.
- Forward curved impeller in galvanized sheet steel.

Finish:

- Anti-corrosive in pre-lacquered steel sheet and aluminum.

Motor:

- High efficiency EC Technology motors



**EC TECHNOLOGY MOTOR** with integrated electronics

## Order code

|  |  |  |                  |                  |           |
|--|--|--|------------------|------------------|-----------|
| <b>CJBD/EC/ALS</b>   | <b>2525</b>  | <b>4M</b>  | <b>3/4</b>       | <b>IE4</b>       |           |
| ↓  | ↓  | ↓  | ↓                | ↓                |           |
| CJBD/EC/ALS: Ventilation units with aluminum profile, double insulating wall and EC Technology IE4 motor with integrated electronics | Impeller size mm<br>mm    inch<br>1919   7/7<br>2525   9/9<br>2828   10/10<br>3333   12/12 | Number of motor poles<br>4=1400 r/min 50 Hz<br>6=900 r/min 50 Hz | M = Single-phase | Motor power (HP) | IE4 motor |

## Technical characteristics

| Model                        | Equivalence inches | Max. speed (r/min) | Maximum admissible current (A) 230V | Max. electric power (kW) | Maximum flow rate (m <sup>3</sup> /h) | Sound pressure level dB (A) | Approx. weight (Kg) | According ErP |
|------------------------------|--------------------|--------------------|-------------------------------------|--------------------------|---------------------------------------|-----------------------------|---------------------|---------------|
| CJBD/EC/ALS-1919-4M-1/5 IE4  | 7/7                | 1400               | 1.65                                | 0.18                     | 1520                                  | 57                          | 26                  | 2018          |
| CJBD/EC/ALS-1919-6M-1/10 IE4 | 7/7                | 900                | 0.98                                | 0.09                     | 1374                                  | 52                          | 26                  | 2018          |
| CJBD/EC/ALS-2525-4M-1/2 IE4  | 9/9                | 1400               | 1.64                                | 0.37                     | 2400                                  | 65                          | 29                  | 2018          |
| CJBD/EC/ALS-2525-4M-3/4 IE4  | 9/9                | 1400               | 2.37                                | 0.55                     | 3200                                  | 69                          | 30                  | 2018          |
| CJBD/EC/ALS-2525-4M-1 IE4    | 9/9                | 1400               | 3.12                                | 0.75                     | 4200                                  | 70                          | 31                  | 2018          |
| CJBD/EC/ALS-2525-6M-1/3 IE4  | 9/9                | 900                | 1.07                                | 0.25                     | 2785                                  | 60                          | 30                  | 2018          |
| CJBD/EC/ALS-2828-4M-1 IE4    | 10/10              | 1400               | 4.12                                | 0.75                     | 3827                                  | 71                          | 35                  | 2018          |
| CJBD/EC/ALS-2828-4M-2 IE4    | 10/10              | 1400               | 11.04                               | 1.50                     | 5915                                  | 73                          | 37                  | 2018          |
| CJBD/EC/ALS-2828-6M-1/3 IE4  | 10/10              | 900                | 1.10                                | 0.25                     | 3046                                  | 60                          | 36                  | 2018          |
| CJBD/EC/ALS-3333-6M-1 IE4    | 12/12              | 900                | 7.83                                | 1.10                     | 5200                                  | 69                          | 50                  | 2018          |



## Erp. (Energy Related Products)

Information on Directive 2009/125/EC can be downloaded from the SODECA website or the QuickFan selector programme.

## Acoustic characteristics

The indicated values are determined by measuring the sound pressure level and sound power in dB(A) obtained in a free field at a distance equivalent to twice the size of the fan plus the impeller diameter, with a minimum of 1.5 m.

Sound power spectrum Lw(A) in dB(A) per Hz frequency band

|                  | 63 | 125 | 250 | 500 | 1000 | 2000 | 4000 | 8000 |
|------------------|----|-----|-----|-----|------|------|------|------|
| 1919-4M-1/5 IE4  | 42 | 53  | 57  | 61  | 63   | 62   | 61   | 52   |
| 1919-6M-1/10 IE4 | 37 | 48  | 52  | 56  | 58   | 57   | 56   | 47   |
| 2525-4M-1/2 IE4  | 50 | 61  | 65  | 69  | 71   | 70   | 69   | 60   |
| 2525-4M-3/4 IE4  | 54 | 65  | 69  | 73  | 75   | 74   | 73   | 64   |
| 2525-4M-1 IE4    | 55 | 66  | 70  | 74  | 76   | 75   | 74   | 65   |
| 2525-6M-1/3 IE4  | 45 | 56  | 60  | 64  | 66   | 65   | 64   | 55   |
| 2828-4M-1 IE4    | 56 | 67  | 71  | 75  | 77   | 76   | 75   | 66   |
| 2828-4M-2 IE4    | 58 | 69  | 73  | 77  | 79   | 78   | 77   | 68   |
| 2828-6M-1/3 IE4  | 45 | 56  | 60  | 64  | 66   | 65   | 64   | 55   |
| 3333-6M-1 IE4    | 54 | 65  | 69  | 73  | 75   | 74   | 73   | 64   |

## Dimensions mm

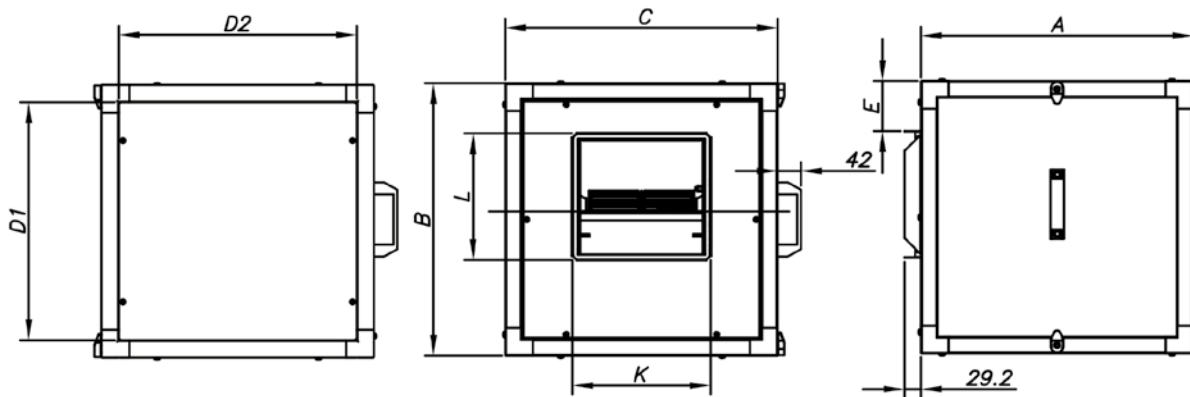

|                  | Equivalence inches | A   | B   | C   | D1  | D2  | E  | L   | K   |
|------------------|--------------------|-----|-----|-----|-----|-----|----|-----|-----|
| CJBD/EC/ALS-1919 | 7/7                | 490 | 490 | 490 | 428 | 428 | 91 | 226 | 247 |
| CJBD/EC/ALS-2525 | 9/9                | 550 | 550 | 550 | 488 | 488 | 86 | 279 | 317 |
| CJBD/EC/ALS-2828 | 10/10              | 605 | 605 | 605 | 543 | 543 | 88 | 306 | 343 |
| CJBD/EC/ALS-3333 | 12/12              | 680 | 680 | 680 | 618 | 618 | 84 | 360 | 404 |

## Characteristic curves

See series characteristic curves: CBD/EC

## Accessories



### Characteristic curves

Q= Flow rate in m<sup>3</sup>/h, m<sup>3</sup>/s and cfm

Pe= Static pressure in mm H<sub>2</sub>O, Pa and inwg

#### 1919-4M-1/5 IE4

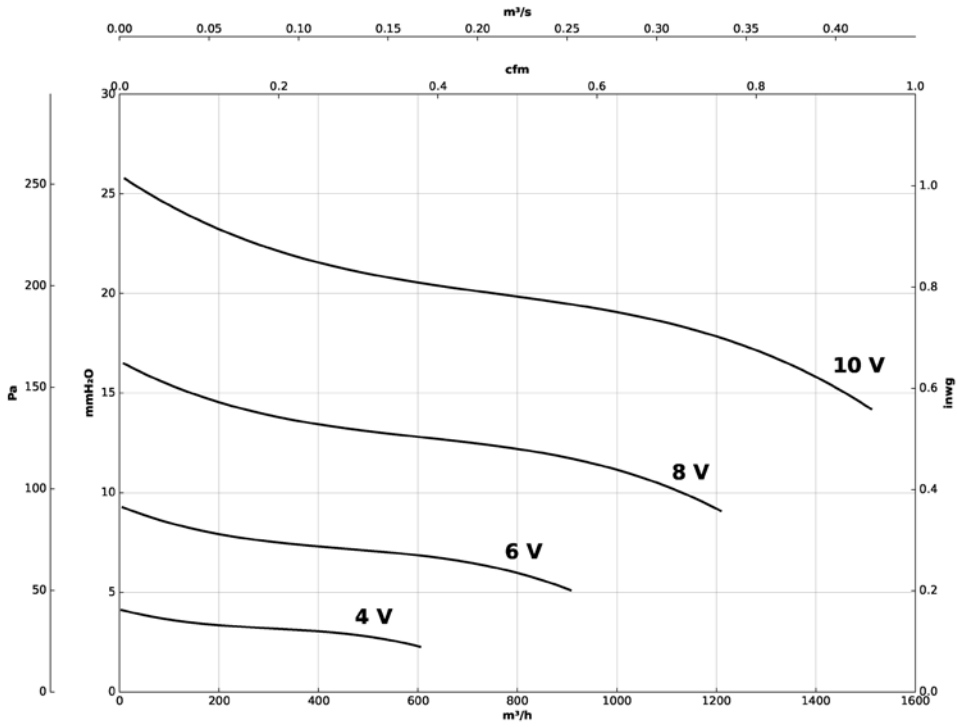

#### 1919-6M-1/10 IE4

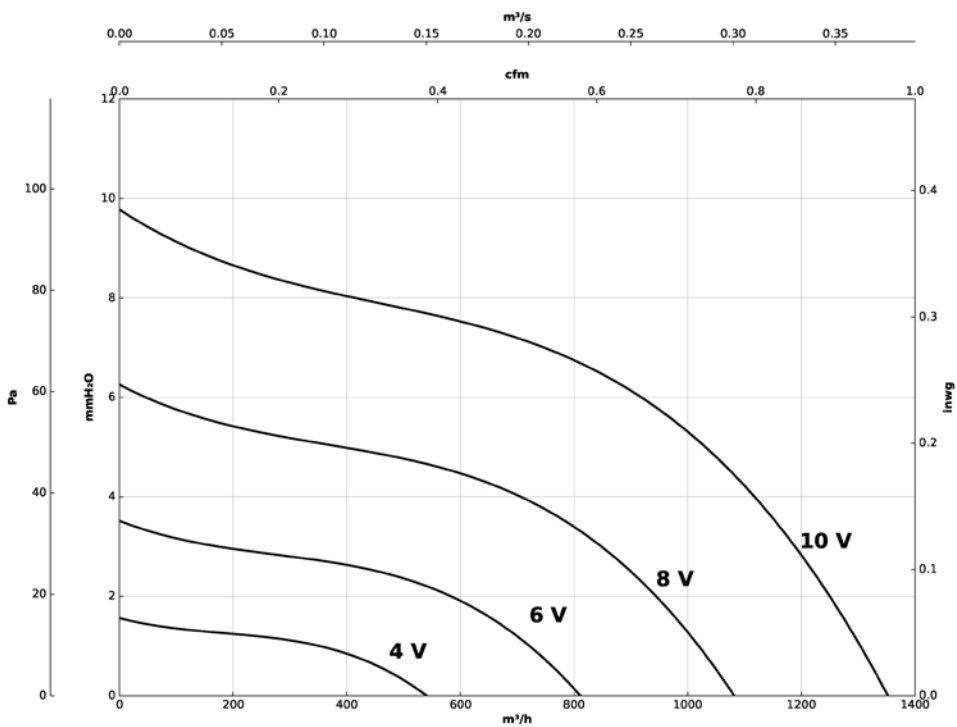

### Characteristic curves

Q= Flow rate in m<sup>3</sup>/h, m<sup>3</sup>/s and cfm

Pe= Static pressure in mm H<sub>2</sub>O, Pa and inwg

#### 2525-4M-1/2 IE4

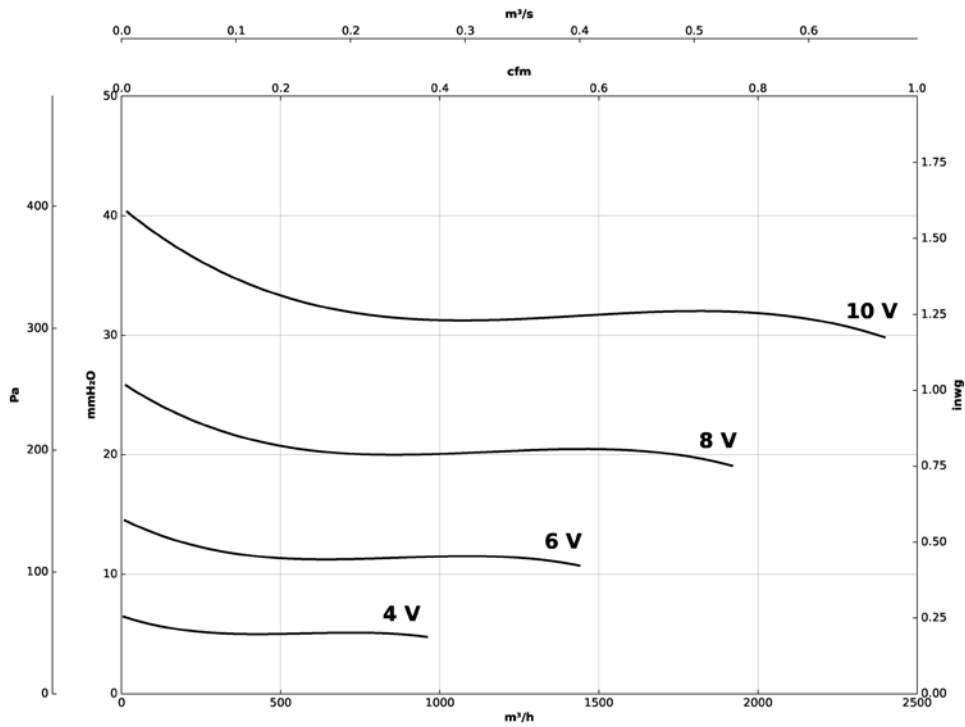

#### 2525-4M-3/4 IE4

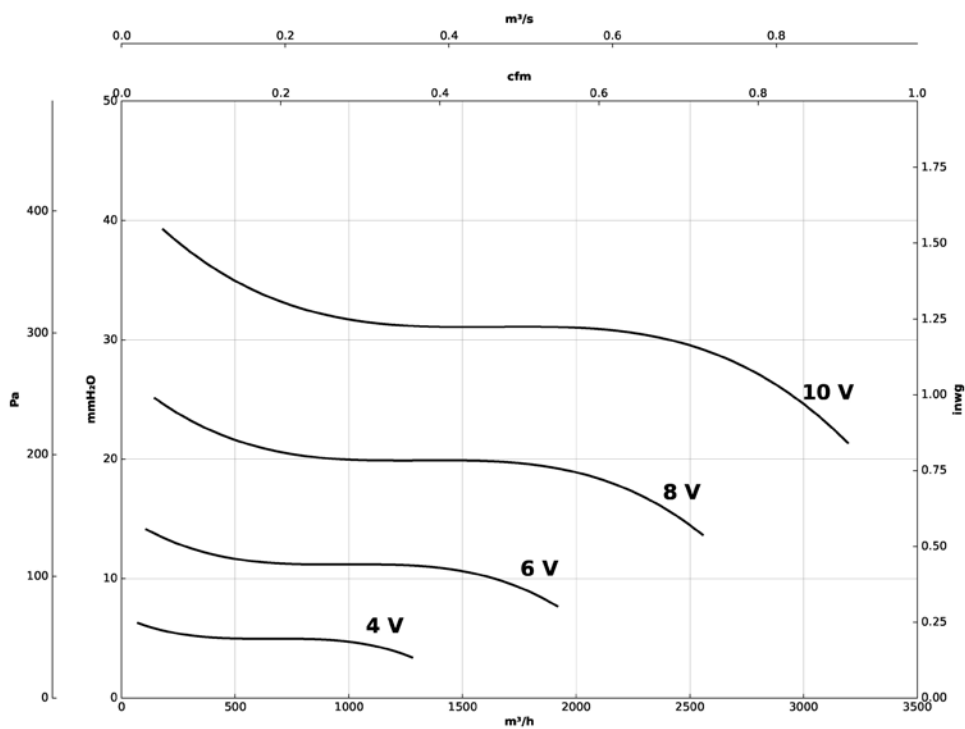

### Characteristic curves

Q= Flow rate in m<sup>3</sup>/h, m<sup>3</sup>/s and cfm

Pe= Static pressure in mm H<sub>2</sub>O, Pa and inwg

#### 2525-4M-1 IE4

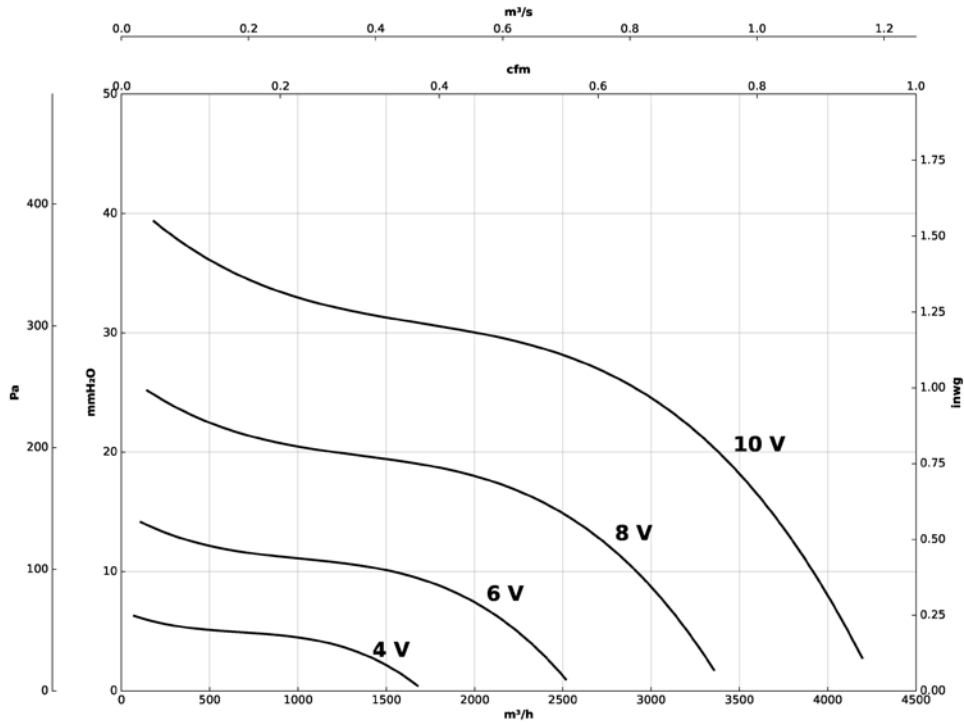

#### 2525-6M-1/3 IE4

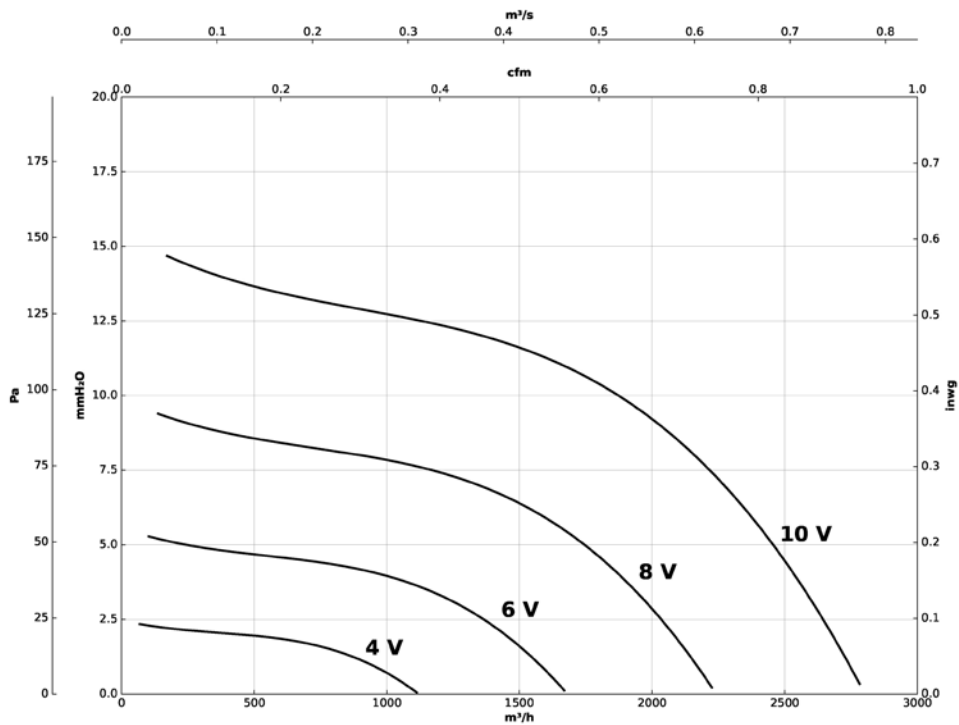

### Characteristic curves

Q= Flow rate in m<sup>3</sup>/h, m<sup>3</sup>/s and cfm

Pe= Static pressure in mm H<sub>2</sub>O, Pa and inwg

#### 2828-4M-1 IE4

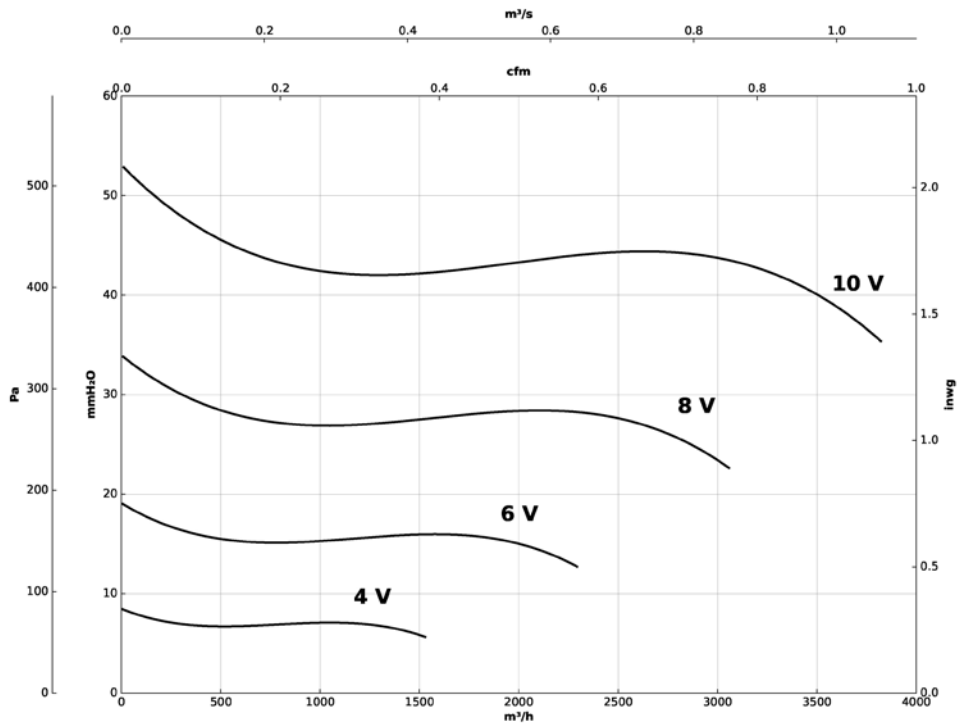

#### 2828-4M-2 IE4

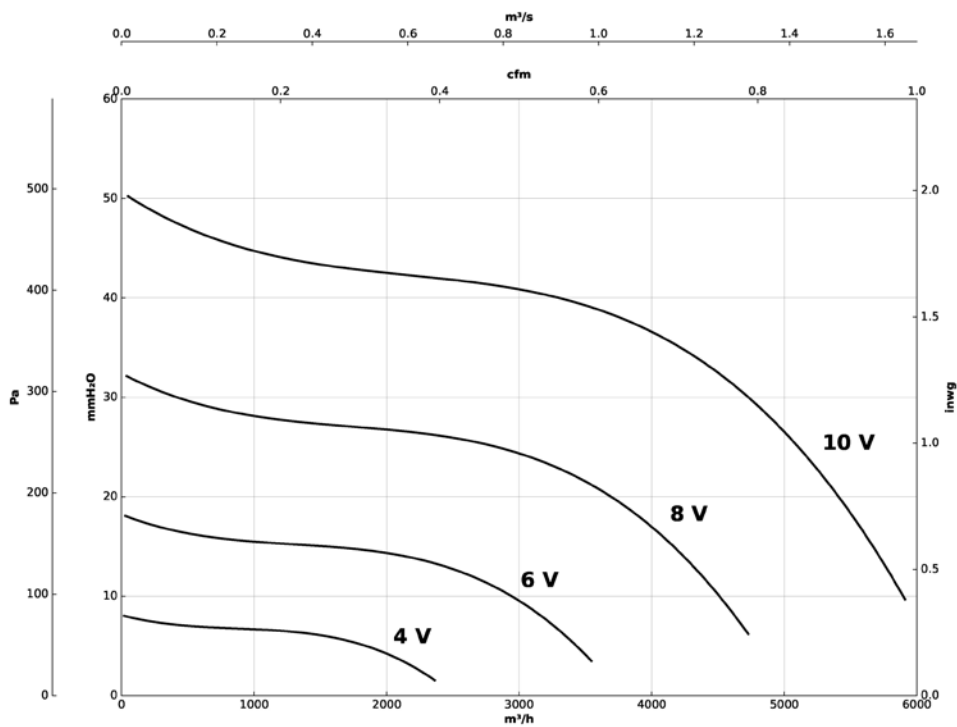

### Characteristic curves

Q= Flow rate in m<sup>3</sup>/h, m<sup>3</sup>/s and cfm

Pe= Static pressure in mm H<sub>2</sub>O, Pa and inwg

#### 2828-6M-1/3 IE4

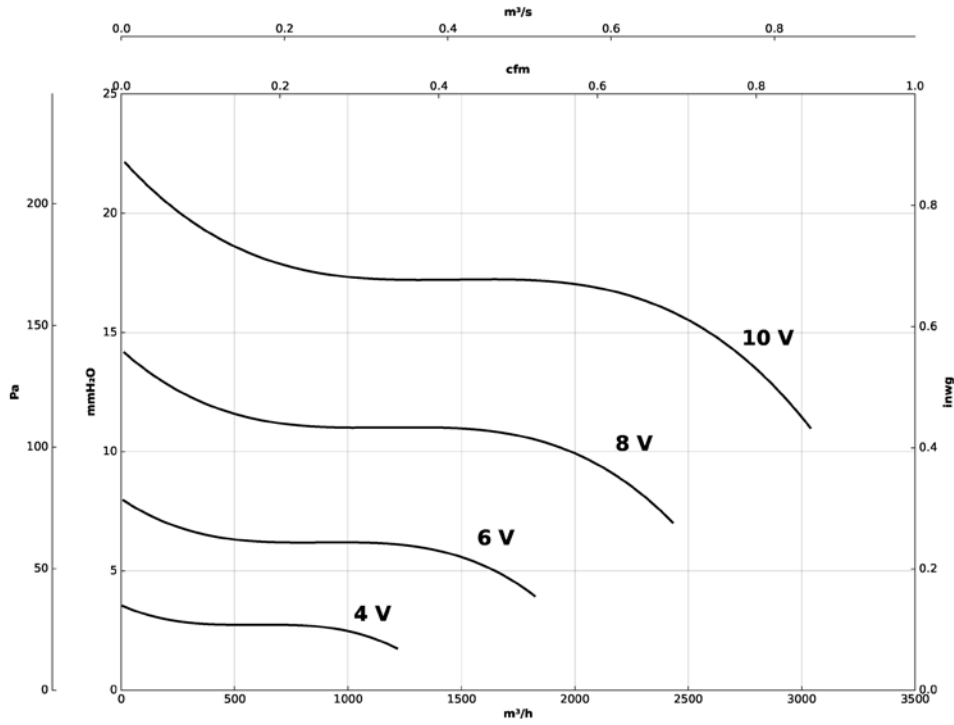

#### 3333-6M-1 IE4

